

# EVOTRON



compliant with the 2013 and 2015 european directive ErP 2009/125/EC (ex EuP)



## EVOTRON WET ROTOR ELECTRONIC CIRCULATORS

### HEATING, AIR CONDITIONING

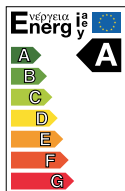

Thanks to the advanced technology employed, **the permanent magnet synchronous motor, and the frequency converter**, the new range of **EVOTRON** circulators ensures high efficiency in all applications, bringing appreciable benefits in terms of energy saving. That's why the entire series of **EVOTRON** circulators is included in energy efficiency class A. The circulator features an electronic device that detects the changes demanded by the heating system and automatically adapts circulator performance accordingly, always ensuring optimal efficiency and minimum energy consumption.

Straightforward operation and an easy-to-ready control panel with display that shows the selected setting at each moment of operation.

Improved and optimized energy consumption overnight (SMART SLEEP Function).

Supplied with a special connector that enables simple and quick electrical connections on installation.

Supplied with an insulation housing kit which adds significantly reducing in heat dispersion.

**Operating range:** from 0,4 to 4,2 m<sup>3</sup>/h with head of up to a 8 mt.

**Liquid temperature range:** from -10°C a +110°C.

**Maximum working pressure:** 10 bar (1000 kPa).

**Protection rating:** IP 44.

**Insulation class:** F.

**Installation:** with HORIZONTAL MOTOR SHAFT.

**Standard voltage input:** single-phase 1x230V/50/60 Hz

**Liquid quality requirements:** clean, free of solids and mineral oils, non-viscous, chemically neutral and approximating the properties of water (max. glycol contents 30%).

**Special versions on request:** alternative voltages and/or frequencies.

CIRCULATORS AND IN-LINE PUMPS

## TECHNICAL DATA - SINGLE

MODEL	CODE	CENTRE DISTANCE mm	ELECTRICAL DATA			UNIONS ON REQUEST		MINIMUM HEAD PRESSURE
			VOLTAGE 50 Hz	P1 RANGE W	In A	STANDARDIZED	SPECIAL	
EVOTRON 40/130	60143302	130	1x230V	5 - 27	0,05 - 0,26	1" F	¾" F - 1¼" M	T° + 90°C m.c.a. 10
EVOTRON 40/130(1/2)	60143355	130	1x230V	5 - 27	0,05 - 0,26	½" F	-	T° + 90°C m.c.a. 10
EVOTRON 40/180	60143358	180	1x230V	5 - 27	0,05 - 0,26	1" F	¾" F - 1¼" M	T° + 90°C m.c.a. 10
EVOTRON 40/180X	60143361	180	1x230V	5 - 27	0,05 - 0,26	1¼" F	-	T° + 90°C m.c.a. 10
EVOTRON 60/130	60143303	130	1x230V	5 - 43	0,05 - 0,40	1" F	¾" F - 1¼" M	T° + 90°C m.c.a. 10
EVOTRON 60/130(1/2)	60143356	130	1x230V	5 - 43	0,05 - 0,40	½" F	-	T° + 90°C m.c.a. 10
EVOTRON 60/180	60143359	180	1x230V	5 - 43	0,05 - 0,40	1" F	¾" F - 1¼" M	T° + 90°C m.c.a. 10
EVOTRON 60/180X	60143362	180	1x230V	5 - 43	0,05 - 0,40	1¼" F	-	T° + 90°C m.c.a. 10
EVOTRON 80/130	60143304	130	1x230V	5 - 66	0,06 - 0,60	1" F	¾" F - 1¼" M	T° + 90°C m.c.a. 10
EVOTRON 80/130(1/2)	60143357	130	1x230V	5 - 66	0,06 - 0,60	½" F	-	T° + 90°C m.c.a. 10
EVOTRON 80/180	60143360	180	1x230V	5 - 66	0,06 - 0,60	1" F	¾" F - 1¼" M	T° + 90°C m.c.a. 10
EVOTRON 80/180X	60143363	180	1x230V	5 - 66	0,06 - 0,60	1¼" F	-	T° + 90°C m.c.a. 10

### EVOTRON 40

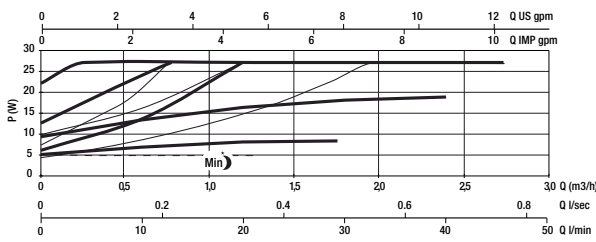
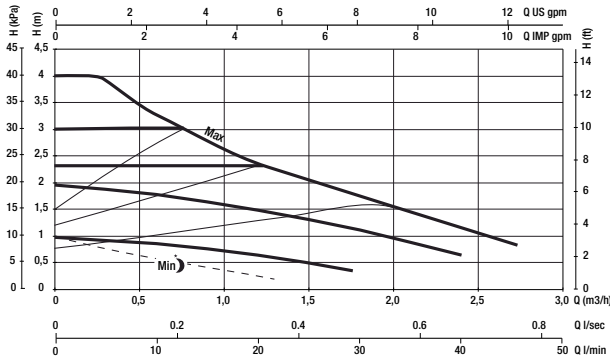

### EVOTRON 60

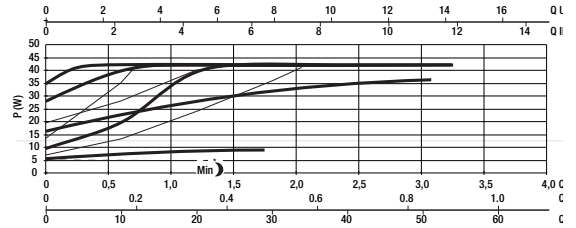
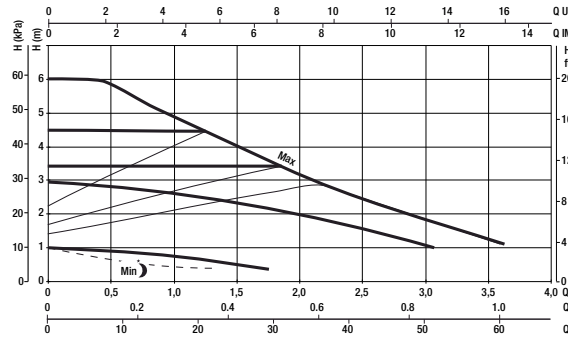

### EVOTRON 80

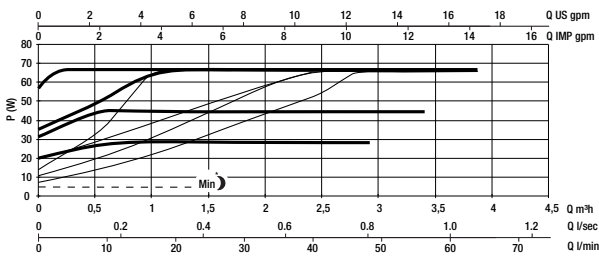
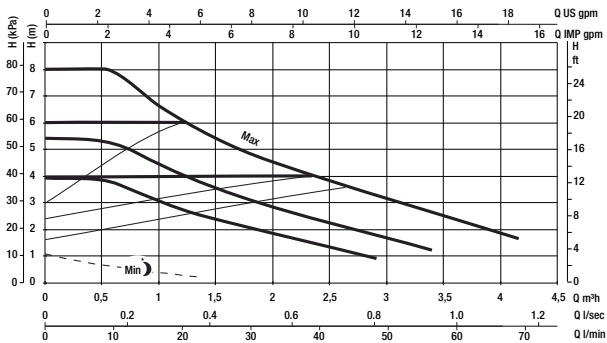

### DIMENSIONS AND WEIGHTS

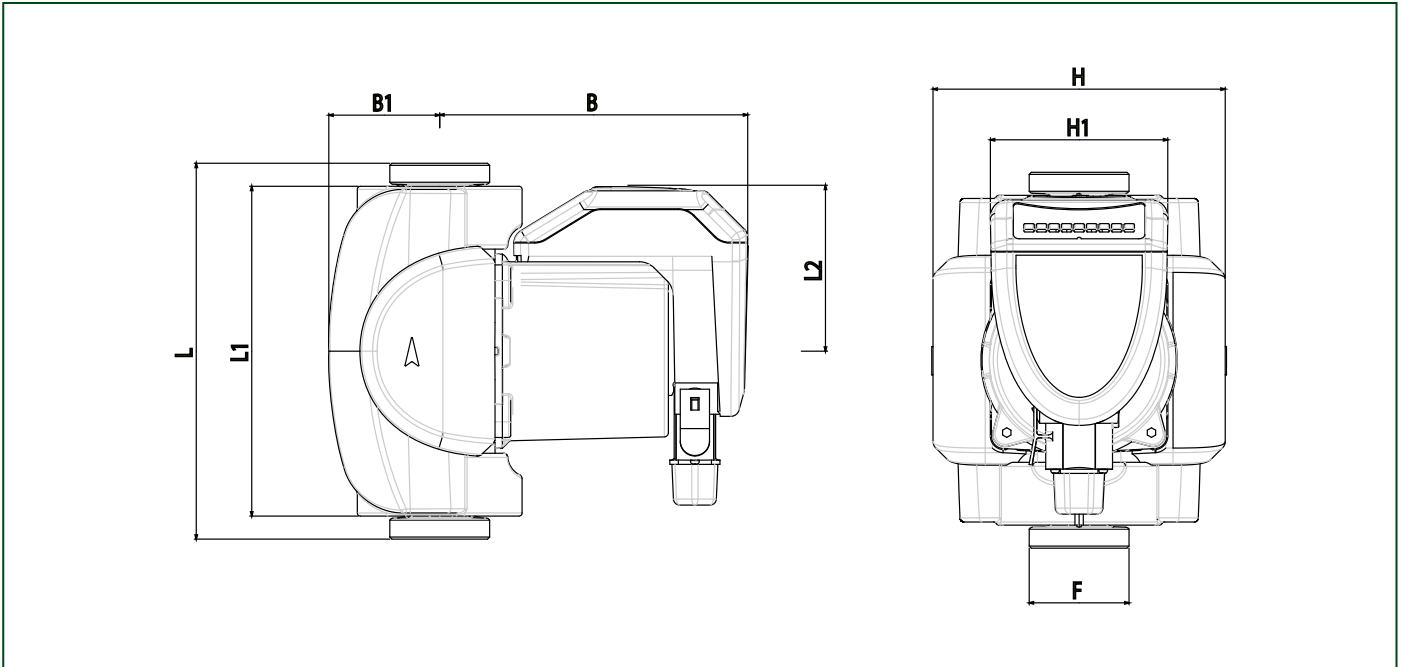

MODEL	L	L1	L2	B	B1	H	H1	F	PACKAGING DIMENSIONS			WEIGHT KG	Q.TY X PALLET
									L	B	H		
EVOTRON 40/130	130	158	79.5	147.5	53	140	85	1 1/2"	148	193	217	2.7	120
EVOTRON 40/130(1/2)	130	158	79.5	147.5	53	140	85	1"	148	193	217	2.7	120
EVOTRON 40/180	180	158	79.5	147.5	53	140	85	1 1/2"	148	193	217	2.9	120
EVOTRON 40/180X	180	158	79.5	147.5	53	140	85	2"	148	193	217	2.9	120
EVOTRON 60/130	130	158	79.5	147.5	53	140	85	1 1/2"	148	193	217	2.7	120
EVOTRON 60/130(1/2)	130	158	79.5	147.5	53	140	85	1"	148	193	217	2.7	120
EVOTRON 60/180	180	158	79.5	147.5	53	140	85	1 1/2"	148	193	217	2.9	120
EVOTRON 60/180X	180	158	79.5	147.5	53	140	85	2"	148	193	217	2.9	120
EVOTRON 80/130	130	158	79.5	147.5	53	140	85	1 1/2"	148	193	217	2.7	120
EVOTRON 80/130(1/2)	130	158	79.5	147.5	53	140	85	1"	148	193	217	2.7	120
EVOTRON 80/180	180	158	79.5	147.5	53	140	85	1 1/2"	148	193	217	2.9	120
EVOTRON 80/180X	180	158	79.5	147.5	53	140	85	2"	148	193	217	2.9	120